

SEE W/4.00 FOR TOP SLAB THICKNESS & REINF.
SEE W/4.04 FOR JOINT & HATCH DETAIL

PLAN - TOP SLAB

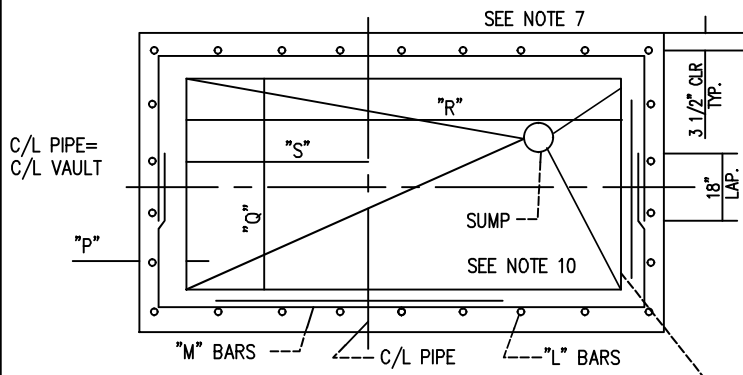

PLAN - TOP SLAB REMOVED

CAST IN PLACE CONCRETE VAULT NOTES

1. $F'_c = 4000$ PSI @ 28 DAYS
2. $f'_y = 60,000$ PSI.
3. VAULTS ARE DESIGNED FOR THE FOLLOWING CONDITION.
 - A. H₂O LOADING & 1'-0" COVER + IMPACT
 - B. 8'-0" COVER & 2'-0" SURCHARGE WATER TABLE 4'-0" BELOW FINISHED GRADE FOR CASES (A) AND (B).
4. CONTRACTOR MAY USE PRECAST VAULT. SEE SPECS FOR SUBMITTAL REQUIREMENTS.
5. PROVIDE ADDNL. "L" BARS 6'-0" LONG EACH SIDE OF ALL PIPES PASSING THRU WALLS.
6. PROVIDE 5" Ø HOLE IN TOP SLAB CENTERED OVER VALVE OPERATING NUTS. PROVIDE VALVE BOXES PER DETAIL W/4.04.
7. SLOPE BASE OF VAULT TO DRAIN @ 1/4"/LF.
8. PROVIDE ADDNL. "M" BARS x 6'-0" LONG TOP AND BOTTOM OF ALL PIPES PASSING THRU WALL.
9. FOR SUMP SEE W/6.12 NOTE #9.
10. VAULTS FOR ELECTRICALLY OPERATED VALVES SHALL BE BUILT WATERTIGHT AND REQUIRE A SUMP PUMP AND FLOOD ALARM CONNECTED TO SCADA. SUBMIT DETAILS FOR REVIEW.

MANHOLE STEPS TO BE CAST INTO CONCRETE.

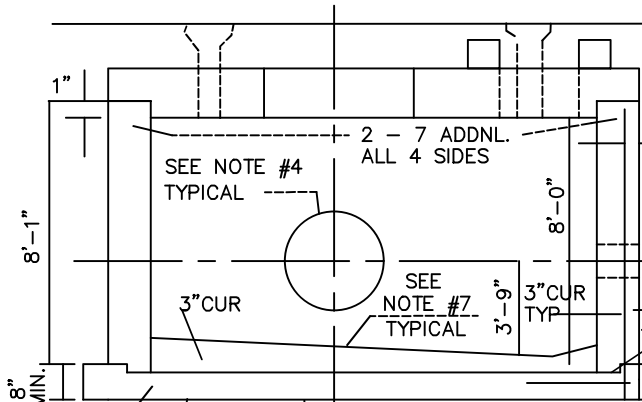

24"	8"	7'-0"	13'-0"	4'-9"	#5@8"	#5@12"	#6@8"
30"	8"	7'-0"	13'-0"	4'-9"	#5@8"	#5@12"	#6@8"
36"	8"	7'-0"	15'-0"	5'-6"	#5@8"	#5@12"	#6@8"

3 1/2" CLEAR
4" TYPICAL
"P" "Q" "R" "S" "L" "M" "N"

PROVIDE 1 1/2" X 3 1/2" KEY - TYPICAL.

VALVE SIZE	"P"	"Q"	"R"	"S"	"L"	"M"	"N"
24"	8"	7'-0"	13'-0"	4'-9"	#5@8"	#5@12"	#6@8"
30"	8"	7'-0"	13'-0"	4'-9"	#5@8"	#5@12"	#6@8"
36"	8"	7'-0"	13'-0"	5'-6"	#5@8"	#5@12"	#6@8"

SECTION



CHARLES COUNTY GOVERNMENT
DEPARTMENT OF PLANNING & GROWTH MANAGEMENT
APPROVED: Raymond N. Shumaker, Jr. Oct 5, 2022
CHIEF OF CODES, PERMITS, & INSPECTION SERVICES
DATE: Oct 5, 2022
PROFESSIONAL ENGINEER

STANDARD DETAIL
CAST IN PLACE CONCRETE VAULT FOR
24", 30" & 36"
HORIZONTAL VALVES

W
3.05
REVISIONS:
JUNE 1995
SEPTEMBER 2022